

NEATH PORT TALBOT COUNTY BOROUGH COUNCIL
CYNGOR BWRDEISTREF SIROL CASTELL-NEDD PORT TALBOT

(ELBA CRESCENT AND BALDWINS CRESCENT,
CRYMLYN BURROWS)
(PROHIBITION OF MOTOR VEHICLES EXCEPT FOR ACCESS)
ORDER 2025

NOTICE is given that the Council on the 29th day of May 2025 made an Order in pursuance of its powers as contained in the Road Traffic Regulation Act 1984, the effect of which is as set out in the Schedule below.

A copy of the draft Order and a plan may be inspected on the Council's Internet Website <https://www.npt.gov.uk/traffic-regulation-orders-tros>.

If any person wishes to question the validity of the Order or of any of its powers on the grounds that it or they are not within the powers conferred by the Act, or that any requirements of the Act or any instrument made under the Act have not been complied with, that person may within 6 weeks from the date upon which the Order was made apply for that purpose to the High Court.

SCHEDULE

Prohibition of Motor Vehicles Except for Access

1.1 Elba Crescent, Crymlyn Burrows.

From its junction with Fabian Way for a distance of approximately 658 metres in a northerly then westerly direction.

1.2 Baldwins Crescent, Crymlyn Burrows.

From its junction with Elba Crescent for a distance of approximately 253 metres in a westerly then north westerly direction.

DATED 30th MAY 2025

M C GRIFFITHS

HEAD OF LEGAL & DEMOCRATIC SERVICES

NEATH PORT TALBOT COUNTY BOROUGH COUNCIL
CYNGOR BWRDEISTREF SIROL CASTELL-NEDD PORT TALBOT

(ELBA CRESCENT AND BALDWINS CRESCENT,
CRYMLYN BURROWS)
(PROHIBITION OF MOTOR VEHICLES EXCEPT FOR ACCESS)
ORDER 2025

The Neath Port Talbot County Borough Council in exercise of its powers under Sections 1 and 2 of the Road Traffic Regulation Act 1984 (hereinafter referred to as “the Act of 1984”) and of all other enabling powers and after consultation with the Chief Officer of Police in accordance with Part III of Schedule 9 of the Act of 1984 hereby makes the following Order:-

1. This Order shall come into operation on the 2nd day of June 2025 and may be cited as the “Neath Port Talbot County Borough Council (Elba Crescent and Burrows Crescent, Crymlyn Burrows) (Prohibition of Motor Vehicles Except for Access) Order 2025”.
2.
 - (1) Except where otherwise stated, any reference in this Order to a numbered Article or Schedule is a reference to the Article or Schedule bearing that number in this Order.
 - (2) The Interpretation Act 1978 shall apply for the interpretation of this Order as it applies for the interpretation of an Act of Parliament.
3. Save as provided in Articles, 4, 5, 6 and 7 of this Order, no person shall cause or permit any vehicle to proceed or be driven across those sides of lengths of roads as set out in the Schedule to this Order.
4. The prohibition imposed by Article 3 of this Order shall not apply to vehicles proceeding or being driven across those sides of lengths of roads set out in the Schedule to this Order for the purposes of obtaining access to land or premises situated on, under or abutting those lengths of roads.
5. The prohibition imposed by Article 3 of this Order shall not apply to Police, Fire, Ambulance or other Emergency Services or to Local Authority Vehicles when in pursuance of statutory powers.
6. The prohibition imposed by Article 3 of this Order shall not apply to Mechanical Cleansing Vehicles whilst engaged in street/drain cleaning operations on behalf of the Neath Port Talbot County Borough Council.

7. The prohibition imposed by Article 3 of this Order shall not apply to Refuge Vehicles whilst engaged in its refuge collecting operations on behalf of the Neath Port Talbot County Borough Council.

SCHEDULE

Prohibition of Motor Vehicles Except for Access

1.1 Elba Crescent, Crymlyn Burrows.

From its junction with Fabian Way for a distance of approximately 658 metres in a northerly then westerly direction.

1.2 Baldwins Crescent, Crymlyn Burrows.

From its junction with Elba Crescent for a distance of approximately 253 metres in a westerly then north westerly direction.

THE COMMON SEAL OF THE)
COUNCIL WAS HEREUNTO AFFIXED)
ON THE 29th DAY OF MAY 2025)
IN THE PRESENCE OF: -)



M. J. Shaw
PROPER OFFICER

Dwg. No.

Job Title

V:\ts180-JCD\Traffic Schemes\T.R.O.Schemes\2024\IC6149S - Elba Crescent, Crymlyn Burrows\IC6149S_01.dwg

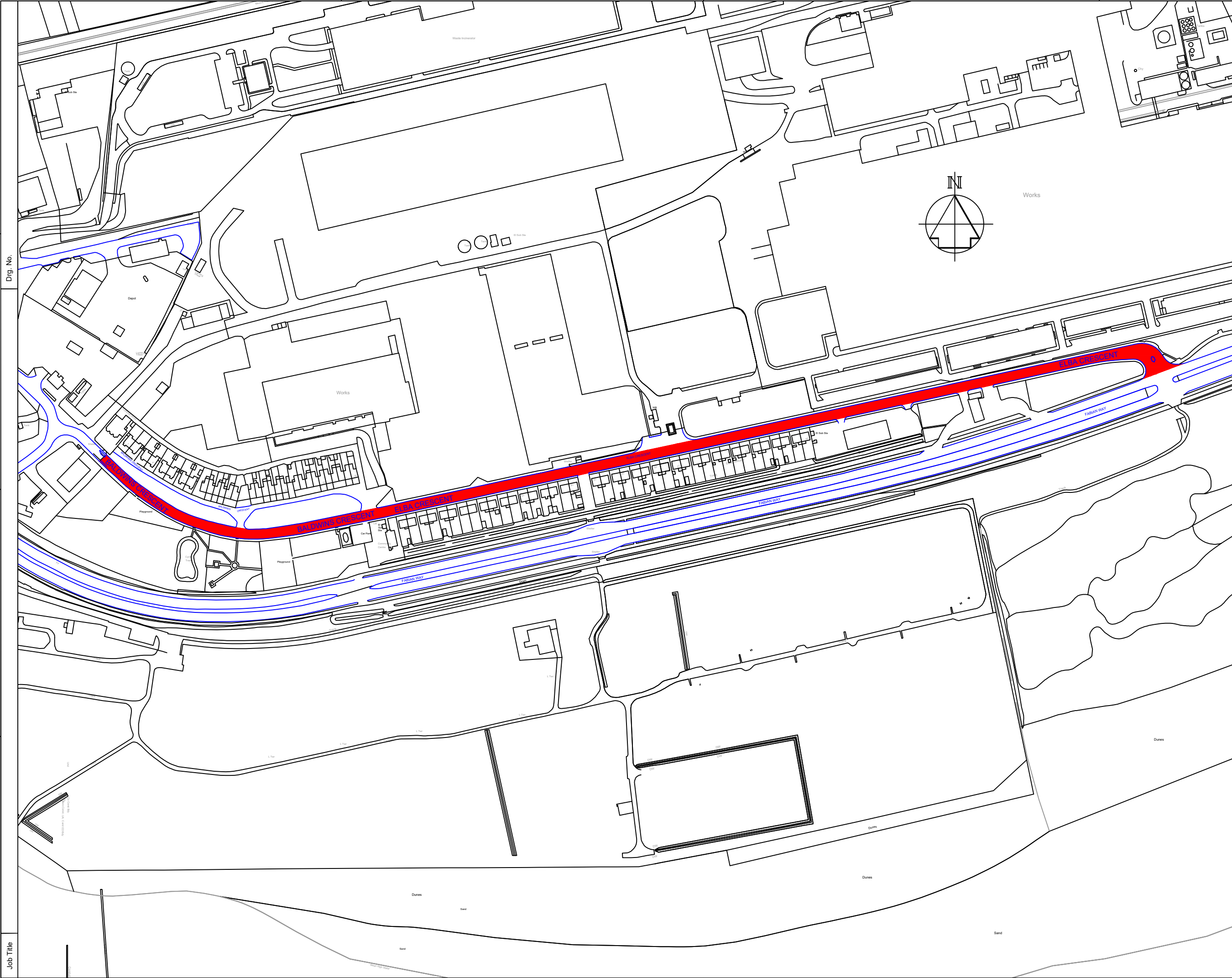

NOTES

1. All dimensions are in millimetres unless otherwise stated.

Key:-

Proposed Prohibition of Motor Vehicles Except for Access Order

Rev	Details	Dr	Ch	Ap	Date
-----	---------	----	----	----	------

Client



ENGINEERING AND TRANSPORT

NICOLA PEARCE BSC (Hons), Dip TP, MRTPI
DIRECTOR OF ENVIRONMENT AND REGENERATION
THE QUAYS, BRUNEL WAY
BAGLAN ENERGY PARK
NEATH SA11 2GG

Job Title

Appendix A

Proposed Prohibition of Motor Vehicles
Except for Access Order
Elba Crescent
Crymlyn Burrows

File No.	TR10.01	Financial Code No.	26.007500.B054.266406
----------	---------	--------------------	-----------------------

Drawn	JD	Checked	MCB	Approved	HH
-------	----	---------	-----	----------	----

Date	July 24	Date	July 24	Date	July 24
------	---------	------	---------	------	---------

Scales	NTS	Status	
--------	-----	--------	--

Drawing No. C6149S_01