

D58/3131 – PROPOSED TRAFFIC ORDER
NEATH PORT TALBOT COUNTY
BOROUGH COUNCIL
(B4287 CIMLA ROAD, CIMLA, NEATH)
(REVOCAION OF 30 MPH SPEED LIMIT)

ORDER 2024

STATEMENT OF REASON

The proposed scheme is necessary to lower the existing speed limit on the section of the B4287 Cimla Road adjacent to the entrance to Gnoll Primary School in the interest of Road Safety.

NEATH PORT TALBOT COUNTY BOROUGH COUNCIL
CYNGOR BWRDEISTREF SIROL CASTELL-NEDD PORT TALBOT

(B4287 CIMLA ROAD, CIMLA, NEATH)
(REVOCATION OF 30 MPH SPEED LIMIT)

ORDER 2024

NOTICE is given that the Council intends to make an Order under Sections 1 and 2 and Part IV of Schedule 9 of the Road Traffic Regulation Act 1984, the effect of which is as set out in the Schedule below.

A copy of the draft Order, plan and statement of reasons can be inspected on the Council's Internet Website <https://www.npt.gov.uk/traffic-regulation-orders-tros>.

Any objections should be submitted in writing, setting out the reasons thereof, to reach the Head of Engineering and Transport, The Quays, Baglan Energy Park SA11 2GG by 30th October 2024.

If you have any further enquiries regarding this notice please send your email to: environment@npt.gov.uk

SCHEDULE

Schedule 1 – Revocation of 30 MPH Speed Limit

A distance of 214 metres in length starting from the reference point of 16 metres south east of its junction with Eastland Road in an south easterly direction is to be revoked from the below mentioned order ; -

B4287 Cimla Road, Cimla, Neath) (30 MPH Speed Limit) Order 2023

Schedule 1 – Proposed 30 MPH Speed Limit

1.1 B4287 Cimla Road, Cimla, Neath

From a point approximately 16 metres south east of its junction with Eastland Road, Neath for the remaining length of Cimla Road at a distance of approximately 1274 metres and terminates where the road merges into Afan Valley Road.

DATED 9th OCTOBER 2024

M C GRIFFITHS

HEAD OF LEGAL & DEMOCRATIC SERVICES

NEATH PORT TALBOT COUNTY BOROUGH COUNCIL
CYNGOR BWRDEISTREF SIROL CASTELL-NEDD PORT TALBOT

(B4287 CIMLA ROAD, CIMLA, NEATH)
(REVOCAION OF 30 MPH SPEED LIMIT)

ORDER 2024

The Neath Port Talbot County Borough Council in exercise of their powers under Sections 1 and 2 and Part IV of Schedule 9 of the Road Traffic Act 1984 (hereinafter referred to as “the Act of 1984”) and of all other powers them enabling and after consultation with the Chief Officer of Police in accordance with Part III of Schedule 9 of the Act of 1984 hereby make the following Order: -

1. This Order shall come into force on the day of 2024 and may be cited as the “Neath Port Talbot County Borough Council (B4287 Cimla Road, Cimla, Neath) (Revocation of 30 MPH Speed Limit) Order 2024”.
2. (1) Except where otherwise stated, any reference in this Order to a numbered Article or Schedule is a reference to the Article or Schedule bearing that number in this Order.
(2) The interpretation Act 1978 shall apply for the interpretation of this Order as it applies for the interpretation of an Act of Parliament.
3. The provisions contained in Schedule 1 of the Neath Port Talbot County Borough Council (B4287 Cimla Road, Cimla, Neath) (30 MPH Speed Limit) Order 2023 are hereby revoked in so far as they relate to the length of road specified in the Schedule to this Order.

SCHEDULE

Schedule 1 – Revocation of Prohibition of 30 MPH Speed Limit

1.1 B4287 Cimla Road, Cimla, Neath.

A distance of 214 metres in length starting from the reference point of 16 metres south east of its junction with Eastland Road in a south easterly direction is to be revoked

THE COMMON SEAL OF THE)
COUNCIL WAS HEREUNTO)
AFFIXED THIS DAY OF)
2024 IN THE)
PRESENCE OF: -)

PROPER OFFICER

1. All dimensions are in millimetres unless otherwise stated.

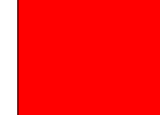
 Existing 30mph speed limit.

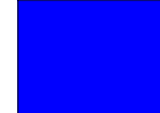
 Proposed revocation of existing 30mph speed limit. This section of the B4287 Cimla Road is proposed to revert to the 20mph default speed limit to encompass the school access.

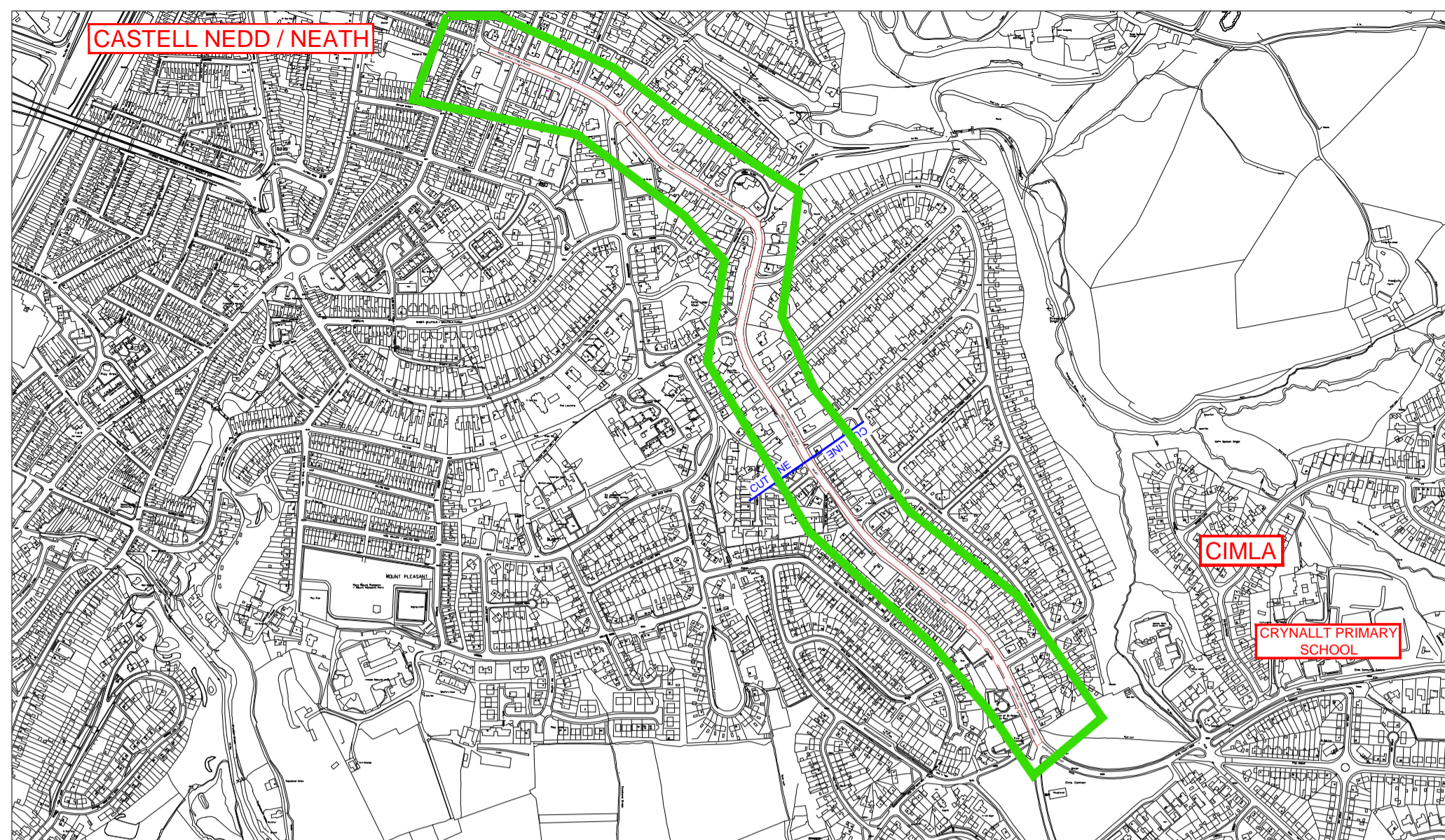

LOCATION PLAN - EXTENT OF THE SPEED LIMIT.
NOT TO SCALE

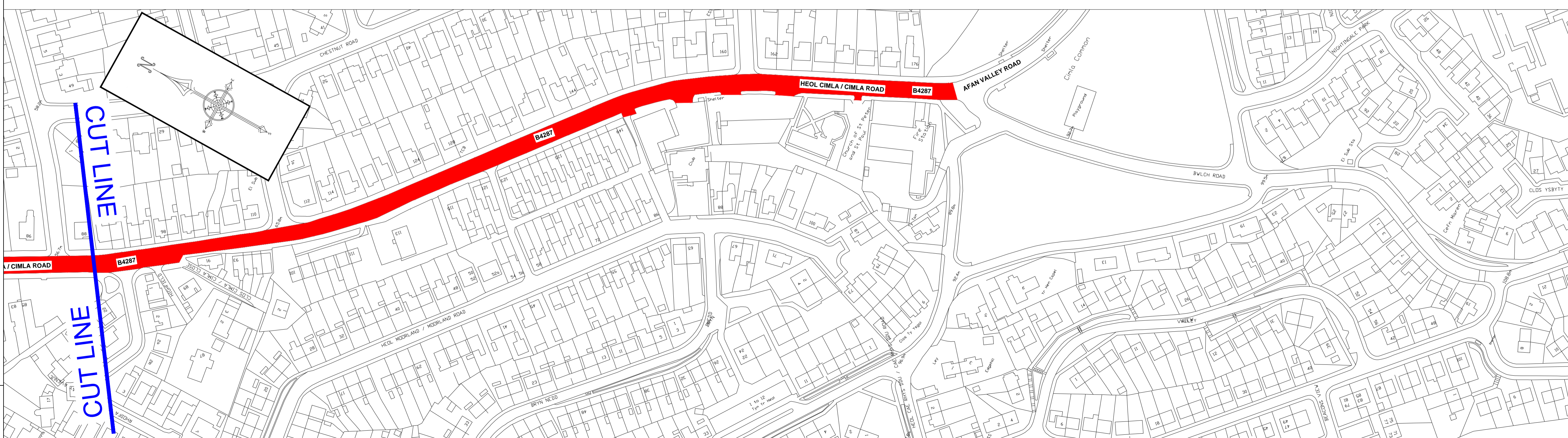
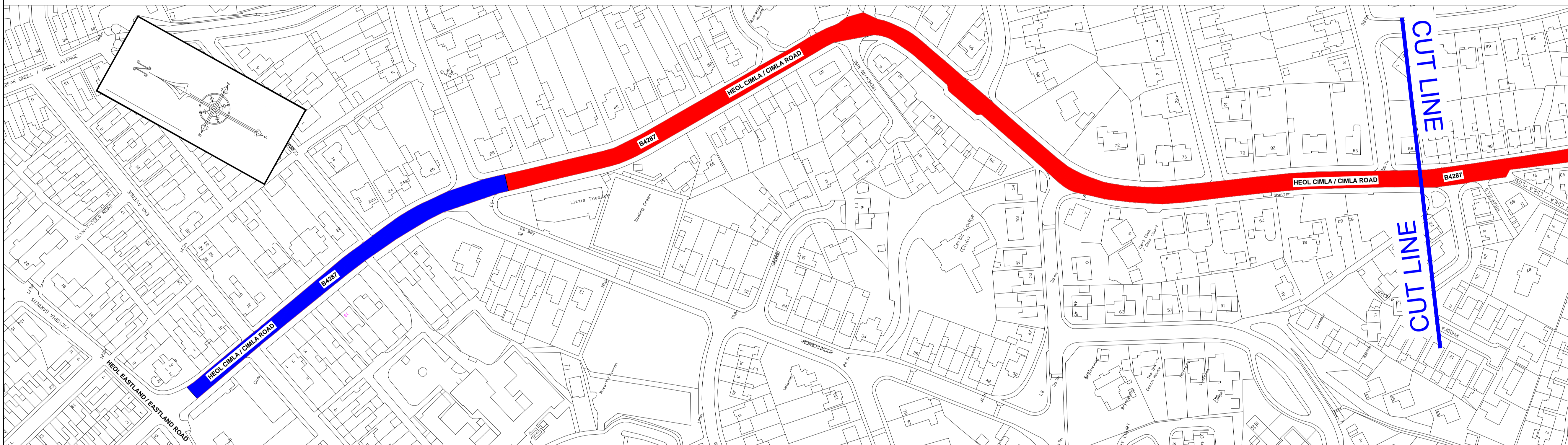

Rev	Details	Dr	Ch	Ap	Date
-----	---------	----	----	----	------

Client



Cyngor Castell-nedd Port Talbot
Neath Port Talbot Council

ENGINEERING AND TRANSPORT
NICOLA PEARCE BSC (Hons), Dip TP, MRTPI
DIRECTOR OF ENVIRONMENT AND REGENERATION
THE QUAYS, BRUNEL WAY
BAGLAN ENERGY PARK
NEATH SA11 2GG

Job Title
B4287 CIMLA ROAD, NEATH
PROPOSED PART REVOCATION OF EXISTING TRAFFIC REGULATION ORDER.

File No.	Financial Code No.				
Drawn	JJD	Checked	MCB	Approved	HIH /JS
Date	SEP'24	Date	SEP'24	Date	SEP'24
Scales	1:1250 @ A1	Status	PRELIM		
Drawing No.	CIMLA-RD/30MPH/TRO1/REVA				

Dwg. No.

Job Title